

CHAIRMAN

Mrs. J. Biddle
Medical Advisory Unit
Martindale Road
Hounslow TW4 7HE

Vice Chairman

Miss R. Dawson
19 Main Street
West Bridgford
Nottingham

Hon. Treasurer

Miss E. Bush
Dept. of Physical Medicine
Hospital for Sick Children
Great Ormond Street
London. W.C.1.

Hon. Secretary

Miss C. Mason
43 Knotts Green Road
Leyton
London. E.10

Newsletter Editor

Miss M. E. Carrington
Hon. P.R.O.
202 Boroughbridge Road
York. YO2 6BD

NEWSLETTER NO.12 AUGUST 1979

The Work of the Advisory Panel of the Toy
Libraries Association

by Miss M. Barton, M.C.S.P. Activities Organiser for
ASBAH at "Five Oaks", Ilkley, W. Yorks

I have been a member of the Panel for over two years and during that time have been involved with others from many disciplines, in testing toys for toy library use and also in discussing the contents of publications produced by the Toy Libraries Association.

The Panel includes a physiotherapist, occupational therapist, speech therapist, educational psychologist, clinical psychologist, social worker, paediatrician, head teacher of a special school, peripatetic teacher for deaf/blind children, Froebel teacher working in a hospital school and an educational adviser for hearing impaired children. There is also a toy designer and consultant, a play equipment designer and a recreational nursing officer both in a subnormality hospital, a parent, a play group and child minder's adviser, a representative from the Special Families Centre in the East end of London, an area children's librarian and an organiser of a Red Cross Toy Library.

The Advisory Panel was formed in 1973 and meets quarterly at the T.L.A. headquarters at Potters Bar. At present a great deal of time is spent on updating the A.B.C. of toys. The draft upon which the Panel have been working is for the seventh edition due out in the autumn. Updating the A.B.C. is a mammoth task as it contains all the toys successfully tested in Toy Libraries!

Toy testing is quite a strenuous activity for both the toys and the testers! Toys are dropped and hit deliberately and it is quite usual to see the representatives from the subnormality hospitals testing toys with their teeth to see if the paint comes off and if the material is tough enough to withstand a strong bite reflex.

Each member of the panel takes the toys for testing to their local toy library so that comments can be collected from several families who have exposed them to normal use at home. At the end of three months i.e.

before the next panel meeting, the tester fills in a standard form which requires details of the toy, its size, number of pieces, material of components, "cleanability" and construction from the safety point of view. In another section is recorded the reactions to the toy by children and by adults, any particular use for certain children/adults and any modifications required before loaning out e.g. varnishing or reinforcement. Finally the tester is required to state whether or not the toy can be recommended and if so under which category it should be placed in the A B C .

At the last Panel 140 toys were available for consideration, 133 were accepted for testing, the rest were either condemned or already known to be in use in Toy Libraries.

The Panel is also concerned with reviewing books received by the Association. Reviews are printed in the T.L.A. publication ARK which is sent to members three times a year.

Because of Baclofen

by Mrs Marion Whyte, M.C.S.P. London
Regional Representative

Recently we have heard and read a lot about Baclofen (Lioresal) as a new drug in the armoury for treating spasticity in children with cerebral palsy. The drug has already been used for some time in the treatment of spinal spasticity in, for example, multiple sclerosis. Physiotherapists have been much involved in various trials to assess the efficacy of this drug. I wonder whether we should be using the opportunity to see what methods we can devise to assess the efficacy of physiotherapy!

Briefly Baclofen is a putative Gamma Aminobutyric Acid mimetic drug. G.A.B.A is a CNS amine involved at synaptic level. There are uncertainties as to Baclofen's precise mode and site of action but there is a hypothesis that it produces changes at cerebral level; it decreases the activity of the gamma fibres leading to a reduction in reflex activity and it acts on the alpha fibres reducing the signal going to the presynaptic site. It is said that Baclofen does not affect normal reactivity in motor neurones.

It is obvious that such a drug, which in theory has such potential for helping to improve the cerebral palsied child, deserves to be looked at more closely and objectively. A number of trials have been carried out at centres throughout the world with somewhat inconclusive results. One of the reasons for this becomes obvious as one reviews the literature available. Although the effects of the drug have been closely observed no concrete evidence is given because we, as physiotherapists, have been unable to provide objective quantitative criteria for measuring changes in the degree of spasticity, and thus to assess the efficacy of the treatment.

We learn for example that - Baclofen helps in "active and passive physiotherapy" (sic) - that a reduction of spasticity was achieved in most children, by a factor of 1 - 2 points on the Ashworth Scale which is a notoriously subjective and, therefore, unreliable test, - that in one centre Baclofen was given, parenterally, one hour before physiotherapy, but no objective evidence was given to justify this invasive procedure.

Thus, so far, physiotherapists have not provided a satisfactory method for evaluating physiotherapy treatment of children with cerebral palsy. Most papers in this field dealing with physiotherapy fail for a number of reasons e.g. too many variables, too few numbers, no controls. Could

we not use the advent of Baclofen to take a new look at the problems of quantitative assessment of the effects of physiotherapy treatment which would not only be helpful to us in evaluating our efforts but also would be of use in testing the efficacy of Baclofen.

A drug has been introduced that may help the functional state of C.P. children (although reduction of spasticity alone will not necessarily restore or increase function). Perhaps we should reconsider the functional state of physiotherapy.

ANNUAL CONFERENCE 1980

Date: 11th, 12th, 13th APRIL, 1980

Theme: The Disabled Adolescent: After School - What?

Venue: Goldsmiths' College, London

General Information

University of London Goldsmiths' College

The College takes its name from the Worshipful Company of Goldsmiths, one of the Livery Companies which grew from London's medieval guilds. In 1904 the Company presented the site and buildings to the University of London, of which the College is still a constituent part.

The main site is grouped around a large and central field, in a surprising and delightful area of green right in the heart of south east London. The original building has remained the core of the College while additional accommodation has been built or acquired to house the increasing number of specialisms which Goldsmiths' has developed over the years. The College now offers courses leading to University of London internal degrees in Arts, Education, Humanities, Music and the Sciences. There is also an extensive programme of evening classes, with some 4000 students attending these non-vocational subjects: Goldsmiths' is a busy place from nine in the morning until ten o'clock at night. Students enjoy the use of bars, cafeterias, etc.

The New Cross campus is only five miles from Charing Cross, and thus within easy reach of all the attractions of central London. Trains from Charing Cross, Waterloo, and London Bridge make frequent journeys to New Cross and New Cross Gate stations, each of which is five minutes walk from the main College building. The train journey is approximately twelve minutes. Tube trains on the Whitechapel branch of the Metropolitan underground line also stop at the New Cross and New Cross Gate stations; and a dozen bus lines pass the door of the College.

A short distance further out from London are the fascinating riverside areas of Greenwich, and the open spaces of Blackheath.

The Halls of Residence which have been put at our disposal are within less than five minutes walk of the College, which is well equipped for, and used to organizing, conferences of all kinds.

Ruth Davies, M.C.S.P.

The greater part of the information supplied here was taken from the Goldsmiths' College Prospectus, 1979 - 80, and is reproduced here with grateful acknowledgement.

PROGRAMME:

The conference is planned to highlight: the psychological problems and the continuing medical, educational, career and leisure needs of the adolescent with physical or genetically determined handicap; the special needs of the mentally handicapped; and the problems facing the parents. It will, we hope, illustrate what should have been done in the past and what needs to be done in the future, to prepare the disabled child for adolescence. Secondly, we wish to discover in which ways the disabled adolescent (once out of the care of the Educational and School Health Services) can best be served by the Remedial Professions.

The speakers will include:

Project Officer of the U.K. Organisation for International Year
of the Child

Mrs. M. Clark (Special Services Adviser, I.L.E.A.)

Mr. S. Dorner (Principal Psychologist, Wessex Unit for Children
and Parents)

Dr. B. Modell (Hon. Senior Lecturer, University College Hospital,
London.)

Miss
M. Oswin (Author: "The Empty Hours" and "Children in Long Stay
Hospitals)

Mrs. C. Patridge (Health Service Research Unit, Canterbury)

Mrs. L. Tuckey (Researcher into Leisure needs of the Disabled)

1979 is the International Year of the Child - 1981 is to be the International Year of the Disabled. We hope that our conference will bridge the year between - as the adolescent is the bridge between the child and the adult.

Conference Co-ordinator: Mrs. M.S.Whyte, M.C.S.P., S.R.P., Senior Community Paediatric Physiotherapist, Child Health 'A', 22/28 Underwood Road, London. E1 5AE

SUMMARY OF WHEELCHAIR MEETING 6th MARCH 1979

In February 1978 the Minister for the Disabled stated that his department intended to carry out a review of the administration of the wheelchair service. Interested organisations were invited to comment and the thoughts of the A.P.C.P. were forwarded to the C.S.P. for inclusion in the report they submitted.

In March 1979 the various working parties involved in the wheelchair review presented their observations, for discussion with the D.H.S.S. and Welsh Office officials. Mrs. J. Biddle attended this meeting.

Attention was drawn to the Fenwick Survey O.P.C.S. (1977) which showed that 91% of wheelchair users were satisfied with their wheelchairs and 93% with the service. Some representatives at the meeting challenged this statement. Major areas of dissatisfaction were:-

- 1) Powered chairs
- 2) Difficulties of the heavily dependent users who need improvements in assessment of needs, appropriate provision, reduction of supply delays and an improved maintenance and repair service

The main points raised during discussion of the recommendations of the working parties were as follows:-

1. Publicity for the service, prescription of chairs and training the professions

- a) A better handbook needed. Last one November 1978
- b) Wheelchair forms. Suggested additions were "Has the patient been tried in the chair/in the chair at home?"
- c) Optional extras should be more detailed e.g. varied arm rest height etc.
- d) Transit chairs could be issued without assessment but other types need a full team assessment with involvement of a therapist and technical officer plus the doctor who should remain in his present role.
- e) Approved centres it was agreed are helpful but costly as is the supplying of demonstration chairs to hospital centres (£100,000 p.a.)
- f) Having a chair "on trial" before making an order would be useful.
- g) Therapist involvement was stressed but adequate information during training would be needed.
- h) D.H.S.S. are updating film "Life on Wheels" and "Wheelchair Section". A new form of tape/slide or film presentation on assessment for children's wheelchairs, active adults and geriatrics is being planned. Miss Mary Barton M.C.S.P., is involved in the preparation of a narrative for the children's part of this film, with Alison Wisbech and Dr. Steven Jarvis.
- i) Conference between Area Limb and Appliance Centres and therapists would help cement links (REG. REPS. PLEASE NOTE !)

Range of Chairs and Delivery

- a) Greater range should be available for those who "lived" in a chair, for young adolescents engaging in sport, for children who need a light chair.
- b) A stand by chair was not favoured by the D.H.S.S.
- c) Centralisation at Blackpool seems to cause delays. A process of decentralisation for powered chairs was being considered.
- d) Controversy over powered chairs was aired. They are really for indoor use but users would like to use them on the street. It was feared that provision of a powered outdoor chair might affect the mobility allowance.
- e) Tricycles for children were discussed. Raleigh are ceasing production of the Lion and Tiger and replacing them with the Bobcat and the Budgie which are two wheelers with permanent outriggers. The D.H.S.S. have arranged with Mrs. Biddle to have these tried out in two or three paediatric centres.
- f) Suitable chairs for the very severely disabled were problematical and the outlook gloomy.
- g) A standard wheelchair should be available in 3 weeks.

Post-Delivery Services, Instruction in Use, Repairs

- a) That there is a written guide for users of wheelchairs is not widely known.
- b) Revision is being made of "Children's Wheelchairs" publication.

- c) People attending schools, centres and hospitals have a therapist available to offer instruction of the use of their wheelchair. Those outside these institutions need a named person to whom they can refer to for help.
- d) Recommenders could indicate on the wheelchair form whether tuition is required or not, particularly with regard to powered chairs.
- e) Pumps should be supplied with the chair with pneumatic tyres. This has been standard procedure since last year.
- f) The department will continue to contact users every three years to see whether all is well and so that unused chairs and accessories can be recovered.

More in our next Newsletter about D.H.S.S. and tricycles for children.

Northern Naidex 1979

Vice Chairman of A.P.C.P., Miss Rose Dawson attended Naidex, held this year at Harrogate, and felt members would be interested in the following:-

1. Totally Soft Play Environment.
System of brightly coloured foam play shapes, mattresses, crawling tunnels, balls and rolls etc., some of which fit into each other. Very useful for the blind, partially sighted, hyperactive or mentally handicapped child.
Available from Hestair Hope Ltd. St. Philips Drive, Royton, Oldham
OL2 6AG
2. Ortho-Kinetics Series 6300 Travel Chair.
A very adjustable and adaptable push chair that can be used as wheelchair, car seat (back wheels fold up) relaxing chair, feeding chair at dining table height or lower. Full range of accessories. From Ortho-Kinetics (U.K.) Ltd., C.C. Division (Dept. T79/5), Unit 24 South Hampshire Industrial Park, Totton, Southampton SO4 3ZU. Useful for the severely handicapped.
3. The Astrid II chair.
Designed for the mentally handicapped adolescent and adult disabled, this chair has a non-clinical appearance whilst being practically upholstered in vinyl. The seat is 16½" high and can be supplied with head rest, tray and harness. The chair is on castors. Available from Woodwork Products, Unit 3, Mochdre Industrial Estate, Newton, Powys, Wales.

Miss Dawson is working on the design of chairs for the severely handicapped in conjunction with an O.T. and a furniture design technician so we wish them success with what must be a difficult project.

Southern Naidex 1979

In conjunction with The Royal Association for Disability and Rehabilitation there will be a conference on "Disabled People and their place in the Community" at Wembley Conference Centre, 21 - 23rd November. Cost £27. Daily rates available. Seminars will be of particular interest to G.P.'s, O.T.'s, Physio's, Social Workers and will include International Year of the Child, Education in the Field of Disability and Technology. Contact The Conference Officer, (P.M.) RADAR, 25 Mortimer Street, London.W1N 8AB
Tel. No. 01 736 5400

The Chance of a Lifetime - 1980

Churchill Travelling Fellowships are open to all U.K. citizens. No qualifications are required. They are of particular interest to people who would not normally be eligible for other types of grants, so enabling them to gain a better understanding of the lives and work of people overseas and to bring back useful knowledge for the benefit of our country. About 100 awards are made annually and there are now about 1,300 Churchill Fellows. Grants are offered in different categories each year. Those relevant to physiotherapists are:- Community Health Workers, Exploration and Adventure, Open Category and possibly Voluntary Service Workers and organisations. Application forms are available from mid-August. To apply send name and address only on a postcard to Winston Churchill Memorial Trust, 15, Queen's Gate Terrace, London., SW7 5PR

The Puppet Centre

Run by the Puppet Centre Trust, the Centre serves the needs of those engaged or interested in amateur, professional or educational puppetry. The Centre has a workshop, reference library, theatre and permanent exhibition of puppets. Courses are held such as the recent one on Puppetry for the Handicapped. Further information from The Puppet Centre, Battersea Arts Centre, Lavender Hill, London, S.W.11 Tel. 01 228 5335

International Year of the Disabled Person 1980

The aim of the year is to encourage the rehabilitation of the 40 million disabled in the world. Anyone with useful ideas about topics that could usefully be examined via radio or T.V. should contact Diana Irish, King's Fund Centre, 126, Albert Street, London, NW1 7NF. Those interested in receiving the I.Y.D.P. Newsletter contact Mr. E. Kosunen, United Nations Office at Geneva, Palais de Nations, CH 1211 Geneva 10. Switzerland

Changes of Address.

1. British Epilepsy Association. Crowthorne House, Bigshotte, Wokingham.
2. Newton Aids Ltd., Dept. N/RT. Dolphin Industrial Estate, Salisbury SP1 2NB Tel.
3. Joncare (Meadjess Ltd.,) Radley Road Industrial Estate, Abingdon, Oxon.

Child Growth Campaign

The Child Growth Foundation which is concerned with research into growth disorders is campaigning for a pituitary gland donor scheme. For further information contact Monica Robb, 2 Mayfield Avenue, Chiswick, London. W.4.

Australian Physiotherapy Association

Western Australia - Paediatrics group

Having exchanged newsletters, it is interesting to note that in Australia a National Survey of Special Education is being carried out and that concern was expressed, in the submission of the paediatric group, at the total educational bias of the survey. To quote "Since therapists and other health disciplines have much to offer in this field, neglect of their contribution was deplored". How similar to our own situation!

EQUIPMENT1. Disabled Living Foundation

The D.L.F. are now producing a one - off aids leaflet which is a selection of ideas from their files which are not commercially produced. The name and address of the person/department to contact for further details of items illustrated is supplied. Further leaflets will be produced at intervals and may be produced as a booklet if demand is deemed adequate. Contact D.L.F. at 346 Kensington High Street, London. W14.

2. Swedish Chair

RIDA chair, available from A.K.T.A., Flemingatten 34 5-112 32 Stockholm, Sweden, has been developed by the Swedish Handicap Institute for Spastic Children to help them increase their mobility and use of hands. The chair is being evaluated at the Bobath Centre where those interested could contact Mrs. Murray on 01 794 6084

3. More on Trikes

A three wheeled scooter and two kinds of tricycle - the "Supa-Byke" and the "Supa-Pedalong" have been designed for handicapped children adolescents and adults with durability and strength in mind. Subnormality hospitals have found the equipment useful. The firm offers a free trial to make sure the individual can really manage safely. Details from W.R.K. Developments, 7 Gilletts Lane, High Wycombe. Tel. H.W. 25529

4. Extras for the Baby Buggy

Extension handles for tall parents and "Twinlinks" which fasten two Baby Buggies together or one Pram Buggy to a Baby Buggy. Mrs. Ewart from Spastics Society, Aids and Equipment, warns against using them with the Lie-Back Buggy.

5. "Peto" Furniture

From Newham Municipal Industries (Newco) 128, West Hame Lane, Stratford, London, E.15. 01 534 4553 Ext.275
Also similar slatted plinths and ladder back chairs, plus a variety of play support items, for nursery and infant children (handicapped or not) from Sherwood Industries. This equipment was on display at the Nottingham A.P.C.P. Conference and looked very interesting. Ask about "Framework". Address:- Sherwood Industries, Rainworth, Mansfield, Nottingham. NG21 0HW. Tel. Blidworth 2151/2

6. Start-Rite Shoes

Now made in a style which laces down to the toe - The Derby Boot. Contact Icknield Shoe Co. Ltd., 18/20 High Street, Royston Herts SG8 9AG. Tel. Royston 43267

7. Meldreth Manor Electronic Aids

Brochure available from the school of aids made and marketed by the pupils 14 - 16 years. Written by Mr. M. Jones, Principal Psychologist and Mr. Ketteridge, Electronic Aids Unit Engineer for the Spastics Society. Address: Meldreth Manor School, Meldreth Nr. Royston, Herts, SG8 6LG

8. Build your own Go-Kart

Designed for the handicapped child by students and staff at Cleveland Technical College, Redcar. Instructions from Mechanical Services Ltd., Bolton, Lancs.

9. Aids Centres for the Disabled.

Permanent displays of equipment which can be discussed and tried out with professional guidance, by appointment, are as follows:-

- | | |
|---------------------|--|
| Birmingham. | Disabled Living Centre, 84 Suffolk Street, Birmingham B1 (Tel. 021 643 0980) |
| Caerphilly. | Aids and Information Centre, Wales Council for the Disabled, Llys Ifor, Crescent Road, Caerphilly, Mid Glamorgan (tel. 0222 869224) |
| Leicester. | Medical Aids Dept., British Red Cross Society 76 Clarendon Park Road, Leicester LE2 (tel. 0533 700747) |
| Liverpool. | Merseyside Aids Centre, Youens Way, East Prescott Road Liverpool L14 (tel. 051 228 9221) |
| London | Disabled Living Foundation, 346 Kensington High Street, London, W14 (tel 01 602 2491) |
| London | Spastics Society Exhibition Centre, 16 Fitzroy Square, London, W1P 5HQ (Tel. 01 387 9571) |
| Manchester | Cripples Help Society, 26 Blackfriars Street, Manchester M3 (tel 061 832 3678) |
| Newcastle upon Tyne | Newcastle-upon-Tyne Council for the Disabled, Aids Centre, Mea House, Ellison Place, Newcastle-upon-Tyne NE1 (tel 0632 23617) |
| Southampton | Hampshire AHA, Southampton General Hospital, Shirley Southampton (tel 0703 777222 ex 3122 or 3414) |
| Stockport | Stockport Aids/Assessment Unit, Stockport AHA, Stepping Hill Hospital, Stockport (tel 061 483 1010 ex 207) |
| Wakefield | Special exhibitions at regular intervals at the National Demonstration Centre, Pinderfields Hospital, Pinderfields, Wakefield (tel 0924 75217 Ex 2510 or 2263) |
| Potters Bar | Toy Libraries Association, Seabrook House, Wyllyotts Manor Darkes Lane, Potters Bar, Herts, EN6 2HL. Tel. 0707 44571 |

FILMS

1. National Society for Mentally Handicapped Children have produced a 26 minute colour film entitled "In a World Apart - or part of the World?" which looks at the organisation's work. From Concord Films Council Ltd., Nacton, Ipswich, Suffolk. IP10 052

2. BBC T.V. "Lost for Words" Series

Earlier this year a series of programmes on speech difficulties was shown on BBC 1, the first three of which covered the problems of the young child, before and during the school years. A leaflet giving summaries of the programmes plus useful names and addresses can be obtained from Lost for Words, BBC Television, London, W1 8QT + large S.A.E.

3. Camera Talks Ltd.

This firm, at 31 North Row, London, W1R 2EN, have available a slide/sound presentation by Mrs. J. Egan, Occupational Therapist, showing the use of a variety of types of furniture for the cerebral palsied child, photographed at Cheyne Walk Centre for Spastic Children.

4. Death and Bereavement

"Living with Death" is a 30 min B/W film showing the way in which people face the prospect of death in a terminal illness - a "Man Alive" programme. From BBC Enterprises, Woodston House, Oundle Road, Peterborough, PE2 9PZ

"Stillbirth" 12 min colour. The mother of a stillborn child explores this experience and stresses the need for understanding. From C.T.V.C. Foundation House, Walton Road, Bushey, Watford WD2 2JF

PUBLICATIONS

1. New Journals

"Sexuality and Disability" - began in 1978. Quarterly from Human Sciences Press, 3 Henrietta Street, London, WC2E 8LU. Articles on the mentally handicapped of particular interest.

"International Journal of Paediatric Oto Rhino Laryngology". Vol.No.1 July 1979. Quarterly from Elsevier/North Holland Biomedical Press, P.O.Box 211, 1000 A E Amsterdam, The Netherlands.

I C T A Inform. Quarterly free of charge from Fack - 161 - 25 Bromma Sweden. This replaces Rehabilitation International's technical aids information sheets.

2. Handicapped Adolescence - a guide

Voluntary Council for Handicapped Children is preparing a guide for those caring for or working with handicapped adolescents covering social, emotional, financial and educational help. Contact them through Mrs. P. Russell, Project Coordinator, if you have any views on contents. Address: 8 Wakeley Street, London, EC1V 7QE

3. From the same address - free Fact Sheets No. 1 - 7 including information on water sports, holidays, play and toys etc.

4. Mucky Play

New leaflet from Toy Libraries Association by Kay Mogford who is a speech therapist and psychologist.

5. A Community Service for mentally handicapped children by Miss A. Shearer 90p. from Barnado's Social Work Dept. Barkingside, Essex, a book about achieving the reality of community care through the creation of a scheme which is sensitive to family needs. A plea is made for joint funding between health and social services to ensure success.

6. Children with Arthritis

A special report by the Arthritis & Rheumatism Council on their problems and the treatment available. 25p post free

When your Child has Arthritis by Dr. B. Ansell.

A parent handbook. 20p post free.

The address of the Council is Faraday House, 8 - 10 Charing Cross Rd, LONDON. WC2H 0HN

7. The Child with a Medical Problem in the Ordinary School by Christine Orton

65p from Home and School Council, 17 Jackson Lane, Billericay, Essex CM11 1AH

The author is a parent of a child suffering from eczema and writes the book for parents and teachers who need help in understanding the disabilities of children who may be attending ordinary schools.

8. The Special Child - The Teenage Years

A support publication for ITV's series to provide additional guidance in care and management of mentally handicapped teenagers.

From P.O.Box , Newcastle-upon-Tyne NE99 1TN. 90p Cheques payable to Trident International.

9. The Quality of Care

2nd in the series Subnormality in the Seventies , published by National Society for Mentally Handicapped Children. 50p. The report of a Danish study tour on the services for the mentally retarded. From N.S.M.H.C. Book Shop, 86 Newman Street, London W1P 4AR.

NEWS FROM THE REGIONS

Scotland. Regional Representative: Miss C.A.Sobkowiak, M.C.S.P., Royal Hospital for Sick Children, Edinburgh 9.

Oct.18th 1978 at Royal Hospital for Sick Children, Edinburgh, a meeting was convened to form a Scottish Committee:

Chairman.	Miss C.A. Sobkowiak	(Edinburgh - East Coast)
	Mrs A. Murdoch	(Glasgow - West Coast)
	Miss Morag Booth	(Aberdeen - North Scotland)

Two courses have been held March 1979 at The Hospital for Sick Children in Glasgow, a day course on "Infantile Hemiplegia". Course tutor Judy Murray, O.T. from the Bobath Centre,. 60 members attended.

22nd June 1979 University of Edinburgh, a day course on "Bobath Approach to the Management of Cerebral Palsy". Course tutor Mrs. J. Bryce, Principal of the Bobath Centre. This course was greatly oversubscribed and a list of disappointed applicants has been kept until such time as further financial support can be obtained for future courses. 80 people attended. Number of members 56.

North East. Regional representative: Mrs.J.Simpson, M.C.S.P. Prescott Place Stainland, Holywell Green, Halifax, We. Yorks.

June 19th 1979. Evening talk at Broomfield School, Leeds, by Mr. D. Lucas of Leeds University T.V.Centre on "The Use of Audio Visual Recording Equipment". 25 people attended including two non-members. It was a most

interesting and instructive lecture which left members with the feeling that they needed to know much more. Mr. Lucas has offered to run future courses when he takes up his new post in York in September, at the Audio Visual Centre, College of Ripon and York St. John, Lord Mayor's Walk, York. He is well qualified to do so having worked as a teacher and as a producer for the BBC. His particular interest is in teaching the skills required to use the simple back-pack type of equipment rather than the very complex equipment usually beyond the financial reach of most N.H.S. departments. He is well worth contacting!

Future Courses.

1. Saturday 6th October 1979 - Day Course. "The ESN(S) Physically Handicapped Child in a Special Care Unit" at Yorkshire Regional Health Authority Headquarters, Harrogate. No course fee. S.A.E. needed on application to Reg. Rep. for return of map and confirmation. Speakers - Dr. B. Winopur, Consultant Psychiatrist, Meanwood Park Hospital, Bradford, on medical management. Mrs. H. Barrett, Headmistress from Meanwood Park, Educational Miss C. Mason, MCSP London, Physical Management. (Management. Mrs A. Freeman, Educational Psychologist, Calderdale Education Dept. Social Management including speech and language.
2. Saturday 24th November 1979. Day Course at Pendower Hall School Newcastle upon Tyne 4, on "Spina Bifida". Speakers: Mr. M.A. Leonard F.R.C.S. Consultant Orthopaedic Surgeon Newcastle. Recent advances in orthopaedic care. Mrs. P. Oates. Deputy Head, Pendower First Department. Practical Demonstration of Movement and Education. Mrs. D. Reay, Careers Officer for Handicapped School leavers and Mrs. A. Grimshaw, Second Deputy Head of Pendower Hall School. Preparation for leaving school. Mr. R. Espie, LBIST., Orthotist and Mrs. S.J. Hogarth, M.C.S.P. Supt, Newcastle Community Health Services. Latest Developments in Splintage for Spina Bifida Children.
Course Fee Members £3.50. Non members £4.00. Applications to Reg. Rep., Cheques payable to A.P.C.P., N.E. Region.

North West Regional Representative: Mrs. P. Eckersley, 62 Goulden Road, Didsbury, Manchester, N20 9YF

Chairman is Miss A. Grimley. Unfortunately we lose the valued services of Joyce Wallace, as Treasurer but welcome Alison Thomas and Celia Ball on to the Committee. Noble volunteers are required for the vacant posts of secretary and treasurer. Please Contact Pam or Ann.

Future Courses: Autumn Study Day on "Trauma and the Child".
Spring Workshop on "Mental Handicap" and "Problem Orientated Medical Records".

North West will also be involved in Regional research workshop designed by Mrs. Partridge for the D.H.S.S. on 13th - 14th February 1980.

Special Event. Royal Manchester Children's Hospital, Pendlebury will be holding an open day on Sunday 9th September to mark its 150th Anniversary. All welcome.

Midlands and Trent. Regional Representative: Miss R. Dawson, M.C.S.P.
19 Main Street, West Bridgford, Nottingham.

23th June 1979. An Exhibition was held to mark the International Year of the Child in the Victoria Shopping Centre, put on jointly by N.A.W.C.H., Paediatric Nursing Services, P.H. School, and the Occupational Therapists. It provoked a great deal of interest in local work with handicapped and sick children in schools and hospitals.

Sept. 12th. Paediatric Interest Group Meeting on "Support for parents in bereavement and terminal illness. Speaker Dr. Barbor, Consultant Paediatrician. Birmingham are planning two lectures in the autumn on Neuromuscular disorders and Still's disease.
Members 114. 2 New

Wales Regional Representative: Mrs. W. Williams, M.C.S.P.
12 Gellogaer Gardens, Cathays, Cardiff.

This group has recently reformed. A study day on 20th June 1979, at Ely Hospital was organised by Mrs. B. Hagem on "The Care of the Multiply Handicapped Child". It was well attended by A.P.C.P. members and other interested parties. A meeting in October at Preswylfa .Pre-School Assessment Unit is being planned. Contact the Reg. Rep. for details
Members 25.

East Anglia. Regional Representative. Mrs. M.E.Norris, M.C.S.P.
10 Oakfields Road, Knebworth, Herts.

8th May 1979. Stevenage. Talk on "Music Therapy". 21 non members, 17 members attended and found it most interesting.
13th October 1979. Lonsdale School. Day Course on "Bliss symbolics" by special request. It will start at 9.30 a.m. and the day will include the Regional A.G.M. Cost £3.75 members, £4.00 non members. Lunch included. Please apply to Mrs. P.A. White., Lonsdale School, Stevenage.
Members 81.

London. Regional Representative: Mrs. M. Whyte, M.C.S.P., Senior Community Paediatric Physiotherapist, Child Health 'A'
22/28 Underwood Road, London, E1 5AE

Four evening meetings have been held at various venues through the region.

1. "The Child with Spina Bifida - Calipers or Wheelchair?"
Organiser. Marion Whyte.
2. "Sex Education and the Handicapped Child". Organiser: Sandra Hill
3. "Children's Aids, Recent advances in North America". Organiser: Maxine Veach
4. "Recent Advances in the Brace Treatment of Scoliosis". Organiser: Ruth Davies.

Future Courses/Conferences.

1. October 1979. Day Conference "Epilepsy". Organiser Maxine Veach.
2. October 1979 - March 1980. Six Saturday study mornings on recent developments in therapy for the mentally handicapped i.e. Portage system and behaviour modification. Organiser: Marion Whyte
3. March 1980 . Regional A.G.M. and conference "Parent Counselling". Organisers; Ruth Davies and Pat Freeman.

Members 140

Organisers' addresses:

Miss M. Veach, 90 Guinness Trust, John Street, London, E15
Mrs. R. Davies, 6 Gable Court, Laurie Park Avenue, London, S.E.26
Mrs. P. Freeman, 13 Church Avenue, Beckenham, Kent.

South East Regional Representative: Miss P Charon, M.C.S.P.
Physio. Dept. Royal Alexandra Children's Hospital, Brighton, Sussex.

28th Oct. 1979. Crabbett Park, Nr. Crawley, Sussex.
Course on Riding for the Disabled. The meeting will include the Regional A.G.M.

Future Meetings for next spring include "Child cancer - the approaches to tumours in childhood", Queen Mary's Hospital, Carshalton and also "The Use of the Boston Brace in the Management of Scoliosis". Course applications to Miss S.E. Raymond, 58 Gates Green Road, West Wickham, Kent. BR4 9DG
Members 83

South West

Miss D. Wheatley would greatly appreciate a volunteer coming forward to take over the job of Regional Representative so that she may have a well earned rest. Contact her at 22 Glebelands Close, West Stafford, Dorchester, Dorset.

A.P.C.P. Post Registration Education

From a study weekend meeting in June the Association has requested the formation of a standards committee to investigate and update the outline course already formulated by its original working party. This was to investigate more detailed curricula and methods of mounting such post registration courses and to ensure national standards plus regional opportunities for members and eventually to act as a validation committee for any post registration paediatric physiotherapy course in the United Kingdom. Prior to the first meeting of the requested standards and validation sub-committee of the C.S.P. Marion Whyte (Assistant Education Spokesman A.P.C.P.) Cynthia Mason and I will be re-writing our original curricula and writing a report on our study weekend for submission to the C.S.P. for this standards and validation committee in Paediatric Post Registration Courses.

Ann Grimley., Education Spokesman, A.P.C.P.

COURSES

London Region A.P.C.P. Courses not included in Regional Report.

1. 6th Oct. 1979. "Epilepsy" Lecture Theatre, Hospital for Sick Children. Great Ormond Street, London. W.C.1.
Fee: £4.50 members, £5.50 non members. £1.00 students.
Send S.A.E. for application form and programme to
Jean Maugham, M.C.S.P., 16 Lee Road, Greenford, Middlesex.
2. 14th Nov. 1979 "Paediatric Audit and Problem Oriented Medical Records". Royal Free Hospital.
Fee: £1.00. For Senior Physiotherapists only.
Tutor. Miss I. Bromley. M.C.S.P. Apply to Mrs.M. Whyte,
Child Health 'A', 22/28 Underwood Road, London. E.1.
3. 19th Nov. 1979 Mental & Multiple Handicap :Workshop I - Early Intervention - The Portage System.
At King's Fund Centre, Albert Street, London. N.W.1.
Fee: £7 Members, £8. non members. Apply to Mrs.M. Whyte.
4. To Come - Workshop II. Behaviour modification.
Tutor Mr. P. Wilcock, Principal Psychologist, Chase Farm Hospital
Further details from Mrs. M. Whyte.

COURSES OF OTHER ORGANISATIONS

1. Castle Priory College, Thames Street, Wallingford, Oxon. OX10 0HE
Contact Principal, Mrs. J. Knowles, B.A.
6th - 9th Sept. No. 15/51 "Music and Art". For therapists, teachers, care staff. Practical programme of ideas for use with wide range of handicaps. Fee: £29. Residence: £27.75

2. 11th - 12th Oct. "Prevention in Mental Illness and Mental Handicap". Annual Conference of MIND, 22 Harley Street, London
WIN 2ED
3. 22nd - 26th Oct. "Creative Activities with Mentally Handicapped Adults and Children". Residential Course in Bath.
Details from MIND as above
4. 12th - 16th Nov. No. 15/73. Castle Priory College - see above.
"Care of Children with Deteriorating Conditions". For medical, educational and social work staff. Fee: £32. Residence: £37.
5. 16th - 18th Nov. No. 15/74 "Organising Parent Workshops".
• Open to all interested in helping parents towards better observation assessment and teaching of their own handicapped child.
Fee £20. Residence: £18.50. Castle Priory College - see above.
6. 11th - 12th Dec. "A Behavioural Approach to the Management of the Mentally Handicapped - Introduction". Lea Hospital, Bromsgrove, Worcs. Details from Institute for Mental Subnormality, Wolverhampton Road, Kidderminster, Worcs. DY10 3PP

A REMINDER

If you have not paid your subscription yet please contact National Treasurer NOW, or no Newsletter

If you have changed your address you must notify your Regional Representative or probably no Newsletter.

IDEAS from LONDON REGION

1. A SLIPPERY WEDGE-- to enable some handicapped children to enter and leave a wheelchair independently. See diagram

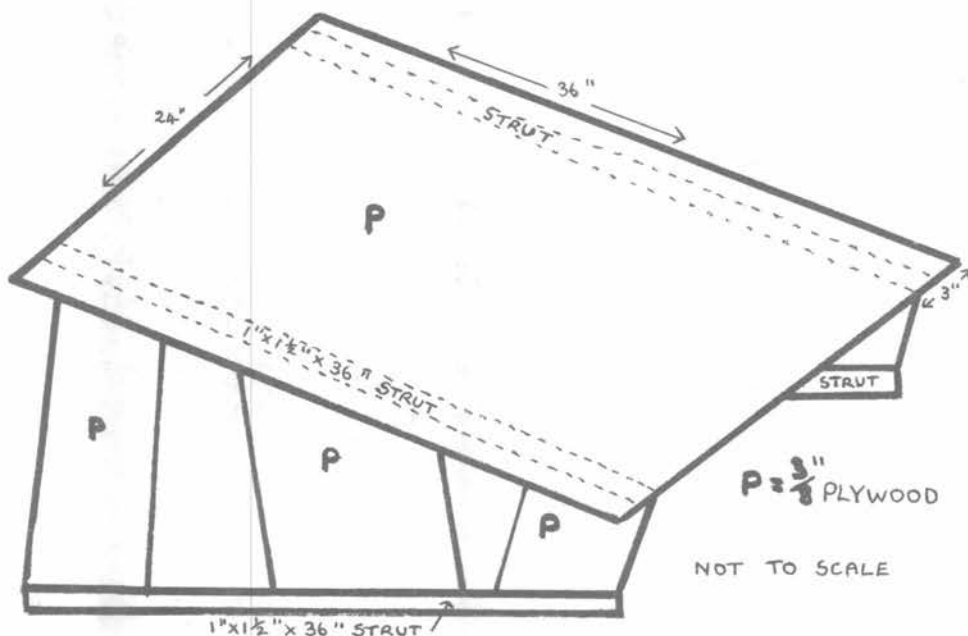

The two sides of the wedge are built as shown. The slippery top is made from $\frac{3}{8}$ " plywood and is 3' long and 2' wide. Side struts are attached approx. 3" in from the sides of the top. Sizes can be varied to suit chair height. Wedge may be extended to ground level with a further small 2' long wedge. Many children manage without this.

2. ADAPTED CYMBALS for Children with poor grip

Severely handicapped children experience great difficulty with conventional strap handles. To make playing easier it has been helpful to substitute rigid handles. See diagram below:-

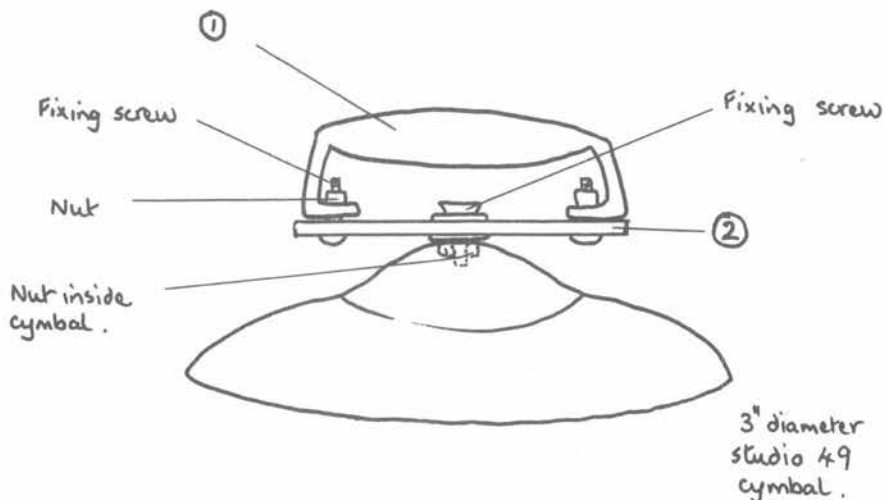

1. Piece of metal tubing flattened at both ends and bent over. The central portion is left circular to aid grasp. Different diameter tubing is used according to size of child's hand.
2. Piece of wood $\frac{1}{4}$ " long $\frac{1}{2}$ " wide, with three holes drilled in it. Remove strap from cymbal and attach wood to it through central hole using a screw, 2 washers and a fixing nut (inside cymbal). The metal handle and wooden support are similarly fixed at the ends of the wood. Do not choose heavy metal tubing as the child will be unable to manipulate the cymbals. Fix screws tightly for safety. A thumb rest and wrist strap (to keep wrist extended) can be incorporated.